



# 54ft XL

## Technical Specifications



## 54ft

To tender are required numerous tasks, the MAORI 54ft is designed to meet every need. Livability, space and protection are the features required for new tender. Designed to expose to the sun the entire surface. the deck, without interruption, does not allow the unused spaces and precious volumes.





## Characteristics

Length overall	16,40 mt
Length Waterline	14,10 mt
Beam max (fenders include)	5,15 mt
Draft	1,02 mt
Displacement	14 tons
Maximum speed	46 kn **
Cruise speed	38 kn**
Navigation category	CE94/25 A
Certification modules	B RINA
N° passenger (crew included)	12
N° Crew	1
Fuel tank capacity	2000 lt
Water tank capacity	400 lt

## Engines

Option A: JOLLYDRIVE surface propeller + FPT 2 x 650 HP

Option B: JOLLYDRIVE surface propeller + Volvo Penta 2 x 725HP

Option C: JOLLYDRIVE surface propeller + MAN 2 X 850HP

The performance is estimated at following conditions: standard version of the yacht at 1/3 of load, clean hull, 25° air temperature, good weather conditions, special props set for those conditions





## Characteristics

The purpose of these Specifications is to describe and explain the project, materials, machinery, equipment and construction of a luxury motor yacht cruises around the world, in accordance with the conditions of use specified in these Technical Specifications. The supply includes all the objects specified hereinafter together with all other items necessary for proper furniture, fittings and equipment of all spaces. Cutlery, crockery, linen, towels, art and decorative items are excluded from the scope of delivery as well as all those items normally not supplied with this type of boats and anything not specified in this specification. Where required for the installation or maintenance of hidden systems, removable panels are installed. The spaces in which no explicit reference is made, nor entirely described in this specification, will be furnished and fully equipped in a proper manner as specified for other similar spaces. The vessel shall be built in accordance with CE-Certification (module B) issued by RINA Services S.p.A. and in compliance with all United States Coast Guard rules and regulations and specifications. The builder shall be responsible for and obtain at its sole cost and expense the appropriate CE-certification (module B) issued by RINA to be delivered at Closing.

## Mooring

Trefoil Stainless steel AISI 316 20 kg anchor, roll for chain cable, safety snap shackle and cam jam.

Stainless steel chain Ø 10mm, 75mt DIN766/ISO.

Anchor launching system with hydraulic folding arm, customized by Maori Yacht, with waterproof control.

Anchor windlass, Electric, Quickmarine, with waterproof control.

Anodized aluminium pop-out mooring cleats: fore (2), aft (2). Seasmart.

Flush stainless steel hull protections from rope scratching.

Fender quick release system, SeasmartSmartlock.

Mooring lines (4), 15 mt, black.

Towing plate in stainless steel.

# MAORI

YACHT





## Maindeck

Metallic paint Dupont.

Fender Fendercare.

Bow sofa/sunbed.

FMG fabric for cushions.

Hull glasses in tempered laminated crystal, fumè. Sovit.

Custom Seasmart hinges, in anodized aluminium.

Custom Seasmart handles, in anodized aluminium.

Deck drainages.

Deck courtesy lights, Quick Marine mod. Tina Led.

Windscreen in tempered layered crystal, Sovit, with stainless steel details with Maori Logo.

Windscreen wiper.

T-Top lights IP66, 6w, Quick Marine mod. Chiara Led.

Electric Pilot seat with foldable seating on STBD side.

3x Electric Guest seat with foldable seating, 1on STBD side, 2 on PORT side .

Custom Large Roll Bar in composite.

2x Custom L shape Sofa, 4 seats with :

- 2x drawer Fridge (35 lt) , stainless steel, Vitrifrigo.
- 2x Table, with electric lifter Linak.

Stern large sunbed with fore-facing sofa, 4 seats.

Engine room hatch with hydraulic rams (2).

Shore Power Marinco 63A.

Water intake, Seasmart.

Fuel intakes (2) at amidships, Seasmart.

Black Water discharge, Seasmart.

Deck in teak, Comilegno first grade, 10mm thick, with grey KENT sealings .

Opac Mare Transformer 3 Step.

Awning system composed by 4 carbon fiber poles and 2 fabrics awnings (1 bow, 1 stern)

Audio stereo system composed by:

- 4x Stern cockpit speaker JL audio M770
- 2x Stern cockpit sub-woofer JL audio
- 2x Bow area speaker JL audio M880
- 2x Cabin speaker Audison APX 6.5
- Cabin sub-woofer 800 W
- 2x Amplifier 8 channel 1500 W
- Radio unit FUSION RA770 Apollo

## Cabin

Central Cabin with:

Custom Pilot Console for 3 monitor

Cabin hatch, with manual sliding movement under console

Fixed side glasses

Air Conditioning Condaria

Custom interior with Galley:

- U-shaped sofa with flipping backrest convertible into a bed space, with drawers
- Strip led recessed lighting, Quick Marine
- Floor hatches, for storage and system inspection
- Freezer + Icemaker Vitrifrigo DW70.
- Fridge Vitrifrigo DW70.
- Induction plate 4 born
- Stainless steel sink with pop up faucet by Artinox model Ghost.
- Work top in marble
- Cushions and mattress in Dedar fabric.
- Ceiling in Foglizzo leather Full Custom O141
- Parquet Corà Ethico
- Furniture finishing in Tabù, matt finishing





## Cabin

Bathroom compartment stbd side whit:

- Bathroom sink Glass Design.
- Tap with mixer and hand-held shower CEA Design.
- WC, Tecma Privilege, Balck.
- Gray Water Discharge System by Vetus.
- Mirror.
- Toilet paper roll holder CEA Design.
- Brush holder CEA Design.
- Ceiling led lights Quick Marine.
- Bathroom air extraction.
- Top and floor in Corian white.





## Propulsion and control

Engines: (2) CAT 8.7 650hp or (2) VOLVO 725hp or (2) MAN i6-800 (800hp) Gearbox ZF (2). External surface Transmissions with coupling bar and dedicated hydraulic steering unit, and internal universal joint shafts (2). JDM. External engines mufflers (2) Elettric bow thruster and stern thruster Three-layer Insulation/soundproofing for Engine Room and Technical Room Blowers and extractors in engine room and technical room, CEM or G&R. Smoke sensor in Engine Room and Technical Room. Steering wheel Isotta

## Systems

Structural fuel tank 1980 lt, with level reported on PLC.

Emergency shut-off valves for fuel lines, with remote control on pilot console.

Primary fuel filters RACOR 75/900 (2).

Stainless steel outboard vent-overfill (2) for fuel tank.

Generator 6kw

Batteries (4) for Engines start 24v. Batteries (6) for services 24v.

Battery cut-off switches. Battery charger 24v Quick Marine 100A.

Battery parallel switch.

Galvanic protection by sacrificial anode.

Engine room and Technical room lighting Quick Marine or similar.

Buttons in deck and Pilot Console, marine-grade IP67, with light ring.

Buttons and plugs inside cabin, Vimar.

Oleodynamic complete system, with manifolds, 24V control units, plus manual pump for backup.

Fresh water tank, 400 lt, with food-grade interior coating, with level indications on PLC, with inspection.

Electronic fresh water pump, 24V, WHALE or similar.

Cold fresh water pipings. Insulated hot fresh water pipings.

Boiler in stainless steel, 230v, 40 lt. ISOTHERM steel series.

Stainless steel outboard vent-overfill for water tank.

Black water tank 75 lt, certified, with macerator pump 24V.

Gray water tank 100 lt, certified, with discharge pump 24V.

Stainless steel outboard vent-overfill for black tank, with anti-odor filters. Underwater waste discharge and dock waste discharge with valves. Engines Seawater intakes, with brass ball valves, filters and certified pipings. Services (Genset, AC, or other optionals) system Seawater intakes, with brass ball valves, filters and certified pipings.

Automatic bilge pumps, RULE 24v, in each compartment.

Bilge double level sensors, with alarm in PLC.

Backup manual bilge pump with valves and suction lines in each compartment.

Engine electronic Throttles, Garmin (Depth Sounder, VHF receiver and antenna, GPS, Multifunction

display 8417MFD), Navigation lights to comply COLREG, Horn, Recessed analog compass 4", in Pilot Console.

# MAORI

Y A C H T

---

Fire extinguishing system for Engine Room, with automatic control and manual control from Pilot Console. Agent: FM-200 non-toxic gas. Approved by RINa. Hand-held extinguishers, 1kg, in each area. Approved by RINa. Life-jackets (16). Approved by RINa. Safety equipment kit for navigation within 50nm from shore, including flares, smoke buoy, light buoy, life ring with rope. Anti-skid knurled flooring in engine room and technical room. Smartboat controls, custom domotic systems. devices display touch screen and ipad





DWL

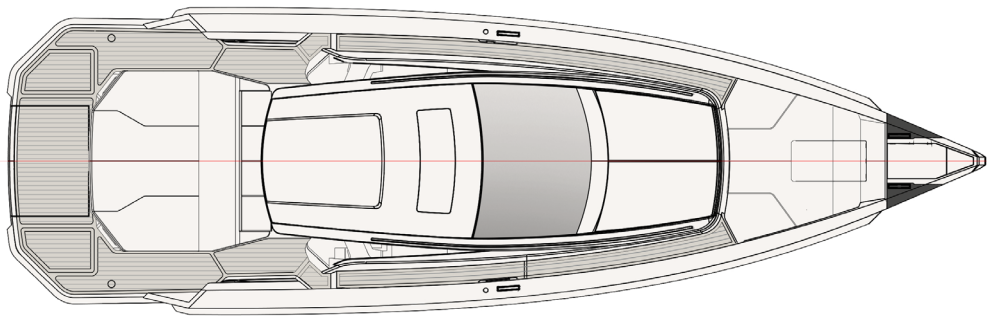

CL

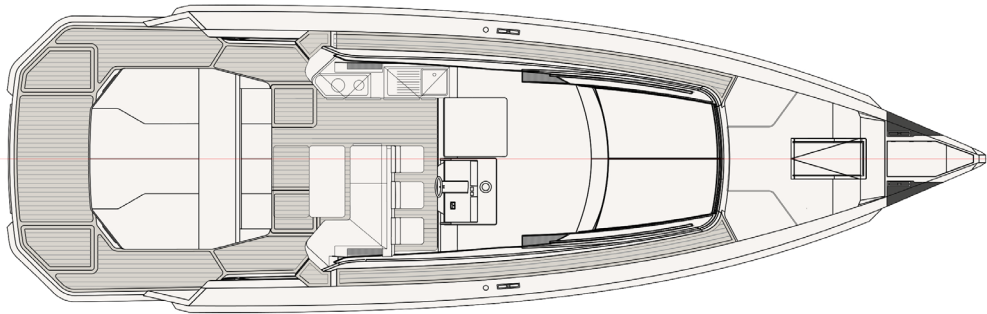

CL

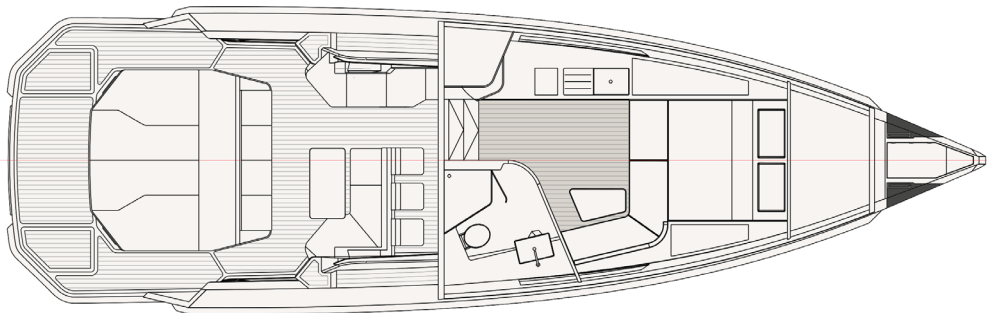

CL